

Ref. : BA 1650.pas

Rev. : Initial

Date : 23/09/2008

Page : 1/1

BALL VALVE FOR WATER METER FULL BORE

BA1650



Tecofi 
VALVE DESIGNER - FRANCE

APPLICATION

Ball valve for water meter.

GENERAL CHARACTERISTICS

Brass valve, brass ball.
Operating by butterfly handle.
Male / free nut ends.

CONSTRUCTION

6	1	Handle	Aluminium
5	1	Packing gland	PTFE
4	2	Seat	PTFE
3	1	Stem	Brass
2	1	Ball	Chromed brass
1	1	Body	Brush brass
Pos.	Qty.	Description	Material

DIMENSIONS

DN		DN1	L	H	P	Weight (kg)
mm	inch					
15	1/2"	1/2"	68,0	40	40	0,17
20	3/4"	1/2"	65,5	40	50	0,22
20	3/4"	3/4"	69,0	40	50	0,23
20	3/4"	1"	69,5	40	50	0,24

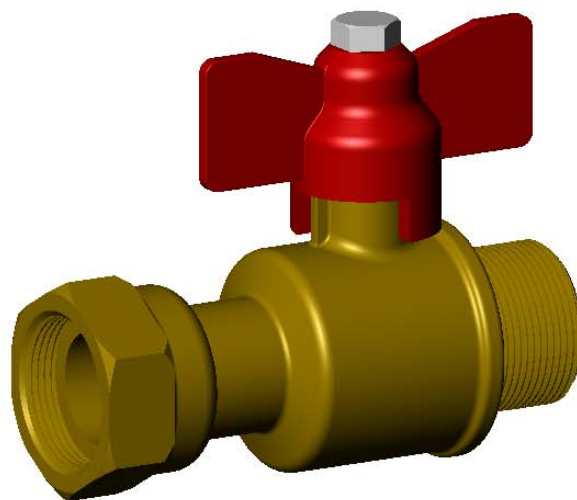

WORKING CONDITIONS

Maximum working pressure : 20 bar.
Maximum temperature : +120°C.

AGREEMENT AND TESTING

BSP threaded according to standard ISO 228-1.

